

## DIMENSIONS

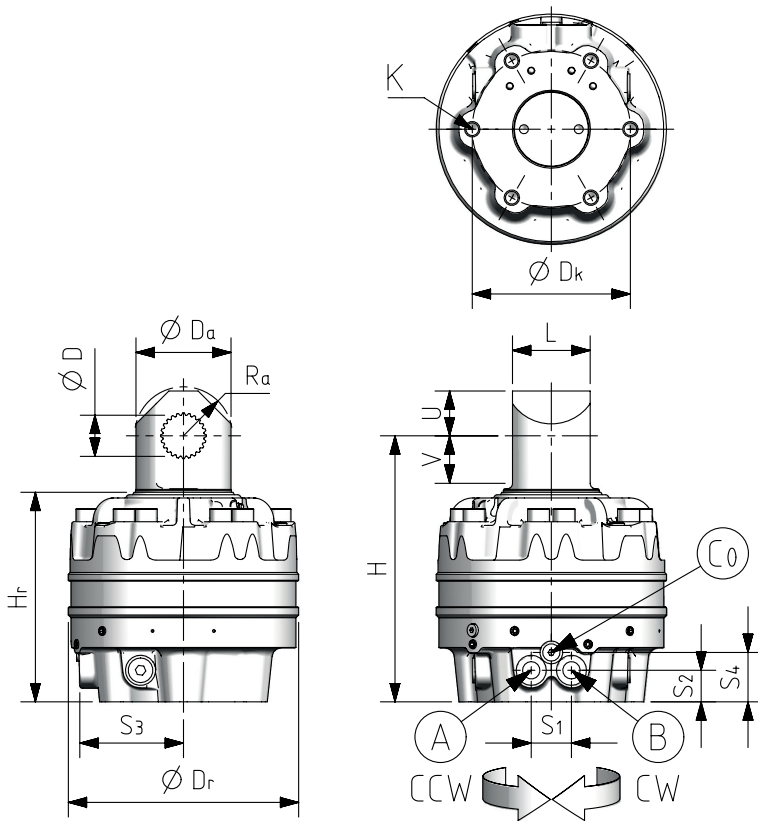

Connections	$P_{max}$
<b>A</b> G1/2" rotate CCW	25 MPa
<b>B</b> G1/2" rotate CW	25 MPa
<b>Co</b> G1/4" case drain	

### Main dimensions

H	291	R	
<b>Dr</b>	252	<b>Hr</b>	227 rotating part

<b>S1</b>	44	<b>S2</b>	34,5	<b>S3</b>	112
<b>S4</b>	54				

### Tool interface dimensions

<b>Dk</b>	173
<b>K</b>	M16 depth 62 (6 x 60°) with $\varnothing 17$ depth 30 clearance

### Link interface dimensions

<b>D</b>	A50x45 DIN5482, through		
<b>L</b>	85 0/-0,15	<b>Da</b>	104
<b>U</b>	49	<b>Ra</b>	54
		<b>V</b>	52

## TECHNICAL DETAILS

### Performance

Axial load capacity	static	$F_{sta}$	160 kN
	dynamic	$F_{dyn}$	80 kN
	compressive	$F_{com}$	65 kN
Torque per 1 MPa		$T$	120 Nm
	max. torque [25 MPa]	$T_{max}$	3000 Nm
Max. rotation speed		$n_{max}$	30 rpm
Total weight		$m$	65 kg

### Link swing damping

none

### Paint

black primary coat

### Hydraulics

Recommended oilflow	$Q_{rec}$	20 l/min
rotation restrictors included		
Displacement per rotation	$V$	788 cm <sup>3</sup>
cross-over relief valves incl.	$p_{lim}$	26 MPa

